

TRANS-CANADA HIGHWAY

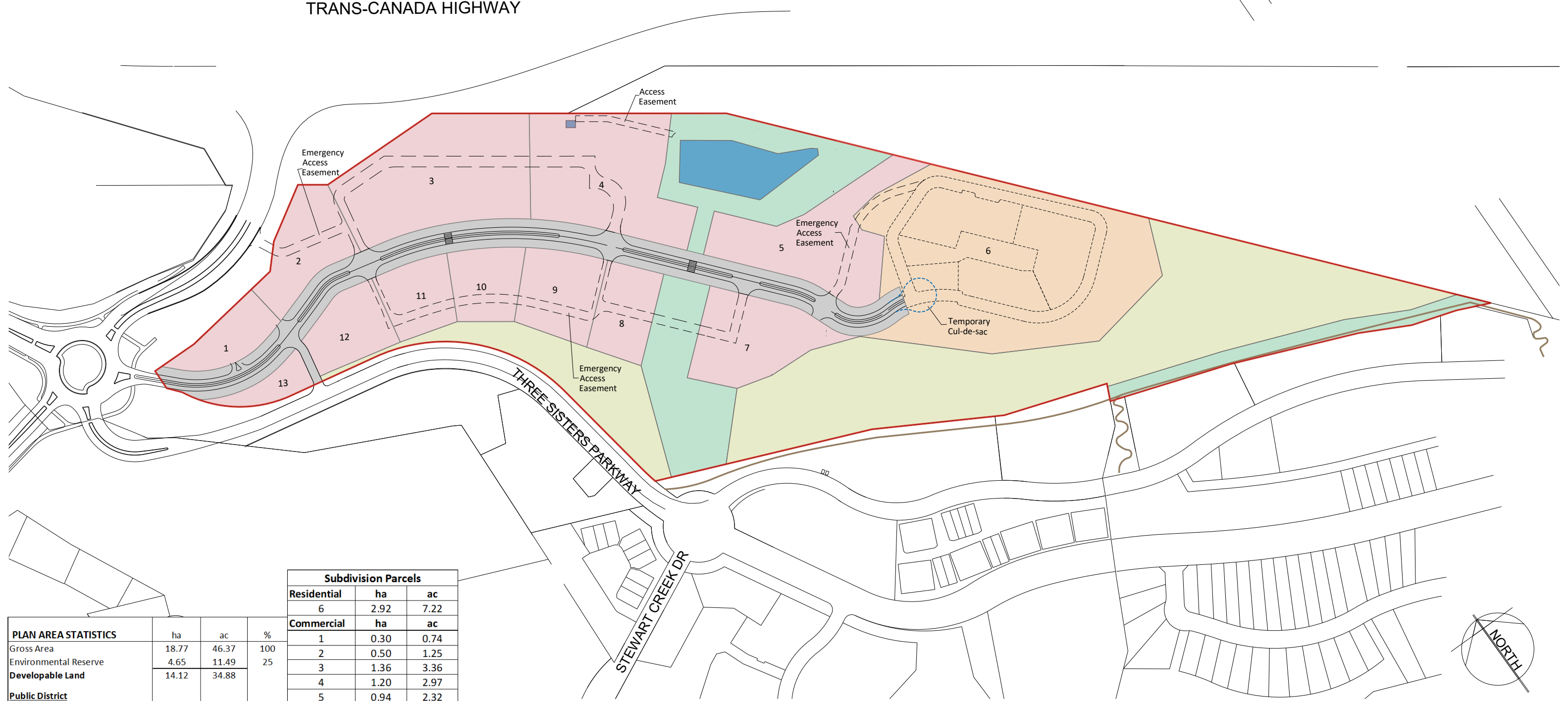

PLAN AREA STATISTICS	ha	ac	%
Gross Area	18.77	46.37	100
Environmental Reserve	4.65	11.49	25
Developable Land	14.12	34.88	
Public District			
Municipal Reserve Proposed	2.07	5.12	11
Municipal Reserve Required	1.41	3.48	
Public Utility Lot	0.40	0.99	2
Roads			
Collector ROW	1.65	4.08	9
Commercial	7.08	17.49	38
Residential	2.92	7.22	16

Subdivision Parcels		
Residential	ha	ac
6	2.92	7.22
Commercial	ha	ac
1	0.30	0.74
2	0.50	1.25
3	1.36	3.36
4	1.20	2.97
5	0.94	2.32
7	0.68	1.68
8	0.38	0.93
9	0.47	1.16
10	0.35	0.87
11	0.35	0.86
12	0.38	0.94
13	0.17	0.41
Total	7.08	17.49

- LEGEND:
- SITE BOUNDARY
 - PUBLIC ROW
 - TS-GD
 - R3 SC1
 - PUBLIC UTILITY LOT
 - MUNICIPAL RESERVE (PD)
 - ENVIRONMENTAL RESERVE (ED)
 - EXISTING TRAIL

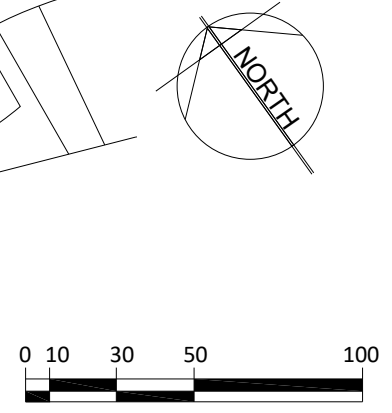

THE GATEWAY AT THREE SISTERS

Legal Address:
 PLAN 1510868, BLOCK 19, LOT 1
 PLAN 0812528, BLOCK 18, LOT 3
 PLAN 0812528, BLOCK 18, LOT 4
 PLAN 0812528, BLOCK 18, LOT 5

SUBDIVISION CONCEPT

Date: December, 2020